

STUD WELDING PRODUCTS, INC.

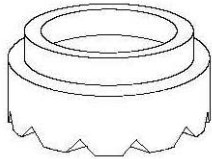

STANDARD FERRULES

SUPPLIED WITH TRU-WELD STUDS



F₁
(Standard Duty)

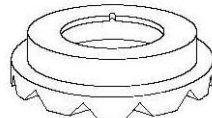

C
(Collar Stud)

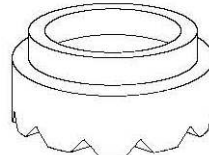

FHD
(Heavy Duty)

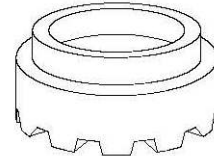

TD
(Thru Deck)



P
(Pitch Diameter Stud)

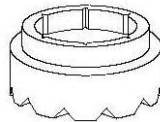

R
(Reduced Base)

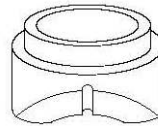

A₂
(Angle Ferrule)

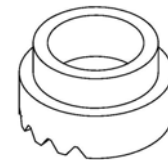

V
(Vertical)

THE TRU-WELD FERRULE (ARC SHIELD) IS SPECIALLY DESIGNED TO WITHSTAND HEAT SHOCK AS WELL AS REASONABLY HIGH TEMPERATURES WITHOUT MELTING OR BREAKING. THE TRU-WELD FERRULE COMPLIMENTS THE UNIFORM FLUX LOAD TO AFFECT A TOP QUALITY WELD.

SPECIAL FERRULES ARE ALSO AVAILABLE UPON REQUEST.

1) THE "F" FERRULE IS ALSO AVAILABLE IN THE LOW PROFILE VERSIONS.

2) THE "A" FERRULE PICTURED ABOVE IS THE COMBINATION INSIDE-OUTSIDE ANGLE FERRULE. THE INSIDE-ONLY AND OUTSIDE-ONLY FERRULES ARE ALSO STANDARD STOCK ITEMS.

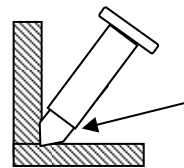

INSIDE ANGLE

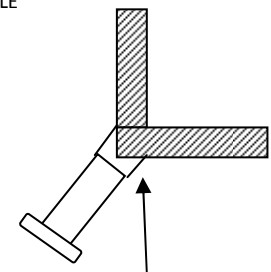

OUTSIDE ANGLE

Check us out on the internet www.studweldprod.com or email info@studweldprod.com

Downey, CA

9459 Washburn Rd.
Downey, CA 90242
Phone- 800.252.1919
Fax- 562.862.3022

Hayward, CA

2391 American Ave.
Hayward, CA 94545
Phone- 510.782.7883
Fax- 510.782.7918

Renton, WA

927 Thomas Ave. SW
Renton, WA 98057
Phone- 425.656.9787
Fax- 425.656.9786

Phoenix, AZ

3535 East Wier Ave., Ste. #4
Phoenix, AZ 85040
Phone- 602.305.9350
Fax- 602.305.4890

STUD WELDING PRODUCTS, INC.

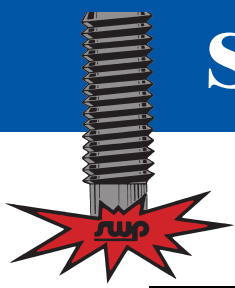

STANDARD FERRULES

TYPE	NOMINAL SIZE	TRU-WELD PART NUMBER	D	H	G	E	
F	3/16	FER03-F	.390	.390 or .250	.281	.156	
	1/4	FER04-F	.455	.390 or .250	.380	.156	
	5/16	FER05-F	.578	.390	.445	.156	
	3/8	FER06-F	.640	.390	.505	.156	
	7/16	FER07-F	.703	.422	.585	.188	
	1/2	FER08-F	.795	.438	.650	.188	
	5/8	FER10-F	1.030	.516	.785	.188	
	3/4	FER12-F	1.218	.656	1.030	.188	
	7/8	FER14-F	1.406	.732	1.210	.188	
	1	FER16-F	1.610	.820	1.406	.188	
FHD	1/4	FER04-FHD	.645	.390	.515	.150	
	3/8	FER06-FHD	.800	.400	.645	.150	
	1/2	FER08-FHD	.875	.455	.785	.185	
	5/8	FER10-FHD	1.230	.520	1.035	.185	
P	1/4	FER04-P	.455	.250	.380	.125	
	5/16	FER05-P	.535	.250	.445	.125	
	3/8	FER06-P	.595	.265	.505	.125	
	7/16	FER07-P	.675	.329	.585	.156	
	1/2	FER08-P	.740	.362	.650	.156	
	5/8	FER10-P	.905	.433	.785	.156	
	3/4	FER12-P	1.150	.526	1.030	.187	
	7/8	FER14-P	1.330	.593	1.203	.187	
	1	FER16-P	1.526	.661	1.406	.187	
R	3/8	FER06-R	.595	.250	.505	.125	
	7/16	FER07-R	.675	.250	.585	.125	
	1/2	FER08-R	.740	.281	.650	.156	
	5/8	FER10-R	.875	.281	.785	.156	
	3/4	FER12-R	1.030	.375	.921	.187	
TD	1/2	FER08-TD	.800	.450	.645	.185	
	5/8	FER10-TD	1.015	.525	.775	.185	
	3/4	FER12-TD	1.335	.600	1.210	.185	
	7/8	FER14-TD	1.528	.666	1.406	.200	

Check us out on the internet www.studweldprod.com or email info@studweldprod.com

Downey, CA

9459 Washburn Rd.
Downey, CA 90242
Phone- 800.252.1919
Fax- 562.862.3022

Hayward, CA

2391 American Ave.
Hayward, CA 94545
Phone- 510.782.7883
Fax- 510.782.7918

Renton, WA

927 Thomas Ave. SW
Renton, WA 98057
Phone- 425.656.9787
Fax- 425.656.9786

Phoenix, AZ

3535 East Wier Ave., Ste. #4
Phoenix, AZ 85040
Phone- 602.305.9350
Fax- 602.305.4890

STUD WELDING PRODUCTS, INC.



STANDARD FERRULES

TYPE	NOMINAL SIZE	TRU-WELD PART NUMBER	D	H	G	E	
C	1/4	FER04-C	.875	.250	.785	.125	
	5/16	FER05-C	.875	.250	.785	.125	
	3/8	FER06-C	.875	.250	.785	.125	
	1/2	FER08-C	1.203	.281	1.045	.156	
V	1/4	FER04-V	.450	.390	.370	.150	
	3/8	FER06-V	.640	.400	.500	.160	
	1/2	FER08-V	.795	.455	.655	.185	
	5/8	FER10-V	1.020	.520	.785	.185	
	3/4	FER12-V	1.220	.660	1.030	.185	
A	1/4	FER04-A	.455	.500	.380	.156	
	3/8	FER06-A	.640	.480	.505	.156	
	1/2	FER08-A	.795	.688	.650	.188	
	5/8	FER10-A	1.030	.875	.785	.188	
	3/4	FER12-A	1.218	.875	1.030	.188	

Check us out on the internet www.studweldprod.com or email info@studweldprod.com

Downey, CA

9459 Washburn Rd.
Downey, CA 90242
Phone- 800.252.1919
Fax- 562.862.3022

Hayward, CA

2391 American Ave.
Hayward, CA 94545
Phone- 510.782.7883
Fax- 510.782.7918

Renton, WA

927 Thomas Ave. SW
Renton, WA 98057
Phone- 425.656.9787
Fax- 425.656.9786

Phoenix, AZ

3535 East Wier Ave., Ste. #4
Phoenix, AZ 85040
Phone- 602.305.9350
Fax- 602.305.4890