

TP INTERNALLY TAPPED STUD REDUCED WELD BASE

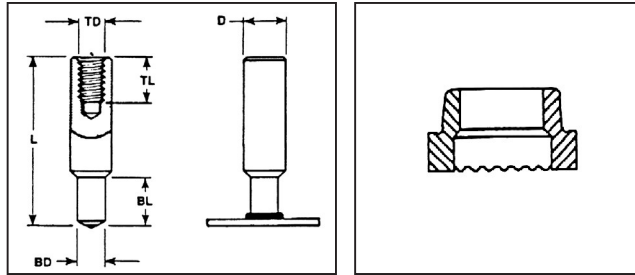

D	Min L	TD	TL*	SWP Part#	BD	BL	Ferrule Part Number
3/8	1-1/2	1/4-20	3/8	call	.250	7/16	FS250
1/2	1-1/2	3/8-16	9/16	call	.375	7/16	FS375
5/8	1-1/2	7/16-14	21/32	call	.500	1/2	FS500
3/4	1-1/2	1/2-13	21/32	call	.500	1/2	FS500
7/8	2	5/8-11	15/16	call	.625	5/8	FS625
1	2-1/2	3/4-10	1	call	.75	5/8	FS750

*Maximum standard tap depth equals 1-1/2 times tap diameter.

Taps: Standard tap is UNC-2B, other taps are available.

HOW TO ORDER
Specify base diameter, finished length before weld (BW) length, tap size, tap depth and type of material.
EXAMPLE
5/8 x 1-1/4" (BW) Tapped Stud (TS) with a 3/8-16 x 7/16 tap, mild steel
When ordering Stainless Steel, SS will be added to the part number.
Diameters 9/16" and below will be 1/8" shorter AFTER weld
Diameters " 5/8 - 7/8" will be 3/16" shorter AFTER weld
Diameters 1- 1 1/4" will be 1/4" shorter AFTER weld

Tapped Studs are used in all types of applications. They can be welded to a flat surface, or to the inside or outside of an angle.

Length: Length is listed before weld. Studs Welding Products TP Studs can be made in any length above the standard minimum. Tru-Deck applications burn off 3/8".

Material: Low carbon steel, ASTM A29, 1010 1020. TP studs are also available in weldable stainless steel.

Low Carbon Mechanical Property Requirements		Stainless Steel
Tensile Strength	61,000 psi min.	Material: Stainless Steel AISI grade - 302/304/305 std. Other grades available upon request.
Yield Strength	49,000 psi min.	
Elongation (% in 2 in.)	17% min.	
Elongation (% in 5x dia.)	14% min.	Mechanical Properties: Values for various grades available upon request.
Reduction of Area	50% min.	

STUD WELDING PRODUCTS, INC.

Los Angeles • San Francisco • Seattle • Phoenix

Toll Free: 800.252.1919 • www.studweldprod.com