

# SS SHOULDER STUDS

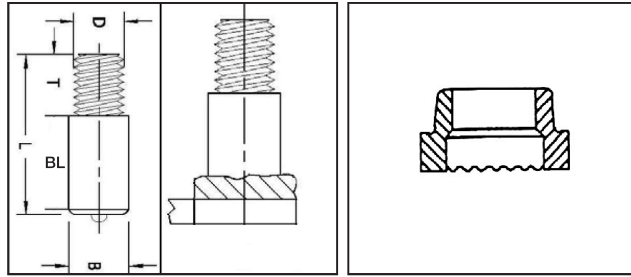

<b>D</b> Thread Diameter	<b>T</b> Min Thread Length	<b>SWP Part#</b>	<b>B</b> Base Diameter	<b>L</b> Min Stud Length	<b>BL</b> min	<b>Ferrule</b> Part Number
1/4-20	3/8	SS 1420 38	3/8	3/4		FER06 FHD
5/16-18	7/16	SS 51618 716	7/16	7/8		FER07 FHD
3/8-16	1/2	SS 3816 12	1/2	1		FER08 FHD
1/2-13	11/16	SS 1213 1116	5/8	1-1/4		FER10 FHD
5/8-11	11/16	SS 5811 1116	3/4	1-9/16		FER12 F
3/4-10	13/16	SS 3410 1316	7/8	1-7/8		FER14 F
7/8-	13/16	SS 78 1316	1/4	1-7/8		FER16 F

\*Also available in metric. See ferrule spec sheet for ferrule specs.

<b>HOW TO ORDER</b>
Specify diameter, thread size before weld (BW) length, type of material.
<b>EXAMPLE</b>
1/2-13 x 1-1/8" (BW) partial thread (PT), mild steel
When ordering Stainless Steel, SS will be added to the part number.
Example: Shoulder Stud Stainless Steel
1/2-13x1-1/8 BW = Part# SMS 1213 118
Diameters 9/16" and below will be 1/8" shorter AFTER weld
Diameters " 5/8 - 7/8" will be 3/16" shorter AFTER weld
Diameters 1- 1 1/4" will be 1/4" shorter AFTER weld

**Shoulder Studs** are used where additional shear strength is required at the weld.

**Material:** Low carbon steel, ASTM A 108 1010-1020. Stainless steel 18-8.

<b>Low Carbon Mechanical Property Requirements</b>		<b>Stainless Steel</b>
Tensile Strength	61,000 psi min.	Material: Stainless Steel AISI grade - 302/304/316. Other grades available upon request.  Mechanical Properties: Values for various grades available upon request.
Yield Strength	49,000 psi min.	
Elongation (% in 2 in.)	17% min.	
Elongation (% in 5x dia.)	14% min.	
Reduction of Area	50% min.	

**STUD WELDING PRODUCTS, INC.**

Los Angeles • San Francisco • Seattle • Phoenix

Toll Free: 800.252.1919 • www.studweldprod.com